

INCOMPARABLE DEEP CYCLE AGM BATTERY

LDC12-53 (12V53Ah)



CHARACTERISTICS

Item	Specifications	
Voltage	12V	
Dimension	Length	197mm (7.76inches)
	Width	166mm (6.54inches)
	Container Height	170mm (6.69inches)
	Total Height	170mm (6.69inches)
Approx Weight	14.2kg (31.3lbs)	
Terminal	T6(M6)	
Container Material	ABS	
Capacity	20HR	53Ah
	5HR	44Ah
Operating Temp. Range	Discharge	-20~55°C (-4~131°F)
	Charge	0~40°C (32~104°F)
	Storage	-15~40°C (5~104°F)

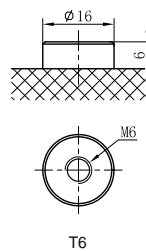
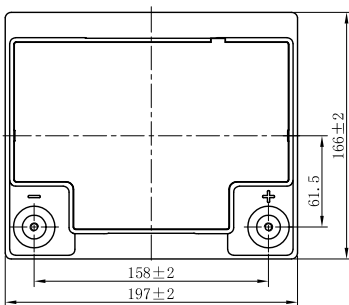
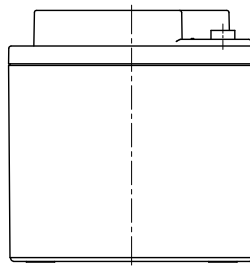
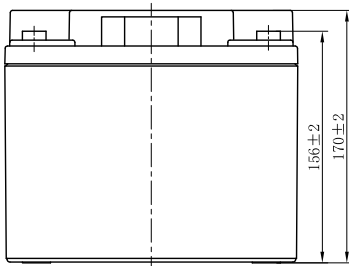

APPLICATIONS

- Electric vehicle
- Golf cart
- Sightseeing
- Cleaning equipment
- AWP
- Mobility

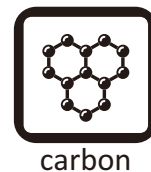

Note: Terminal Torque Values in-lb(Nm):34.39-47.75(3.9-5.4)



INCOMPARABLE DEEP CYCLE AGM BATTERY

LDC12-53 (12V53Ah)



GENERAL FEATURES

Stable initial capacity

- PAM/NAM amount optimization
- 4BS crystal paste mixing & curing technology
- Double layer separator technology
- Improved design electrolyte S.G.

Improved PSoC cycling

- Carbon boost technology
- Mix carbon boost technology
- Targeting for higher level through carbon technology

Excellent deep cycle performance

- Plate assembly pressure re-engineering
- New PAM/NAM recipe introduced
- Gel electrolyte technology
- Rare earth alloy
- Double layer separator technology
- Lower acid filling temperature

Less water loss

- PAM/NAM amount optimization
- New PAM/NAM recipe introduced
- Rare earth alloy

Delay PAM softening and shedding

- Plate assembly pressure re-engineering
- 4BS crystal paste mixing & curing technology
- Higher paste density

Solve NAM sulphation

- Carbon boost technology
- Pre-sulfate technology

Optimize electrolyte stratification

- Introduce AGM-GEL technology

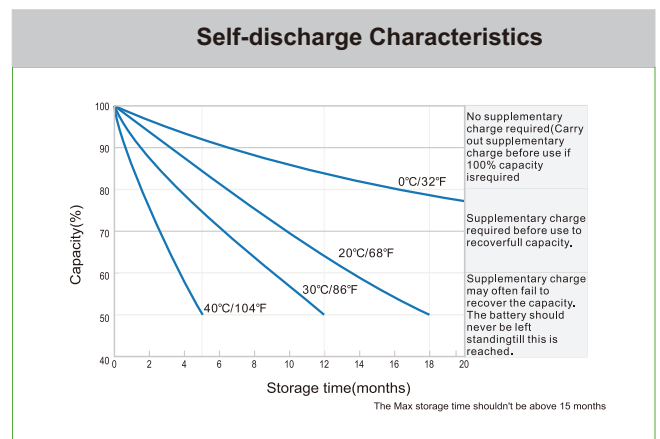
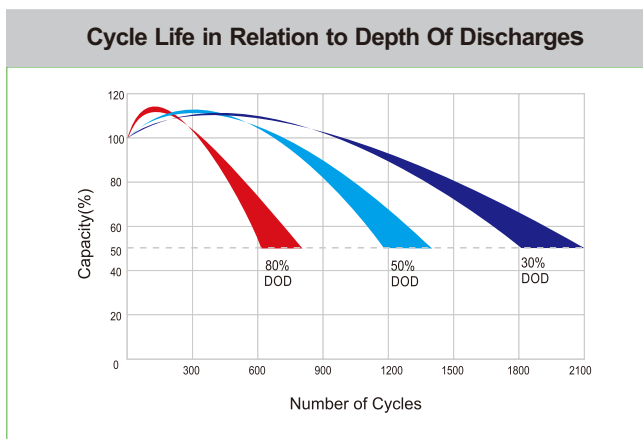
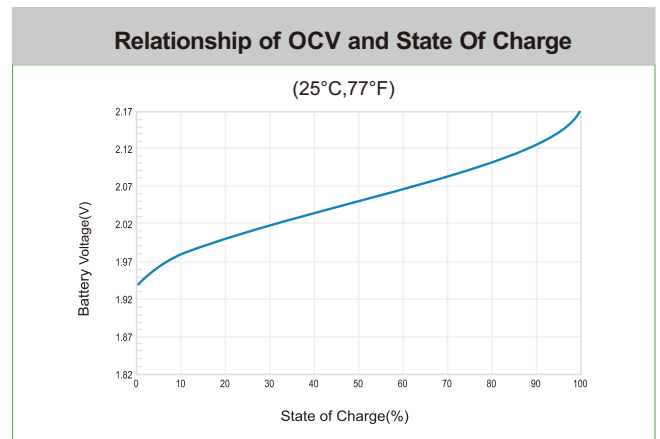
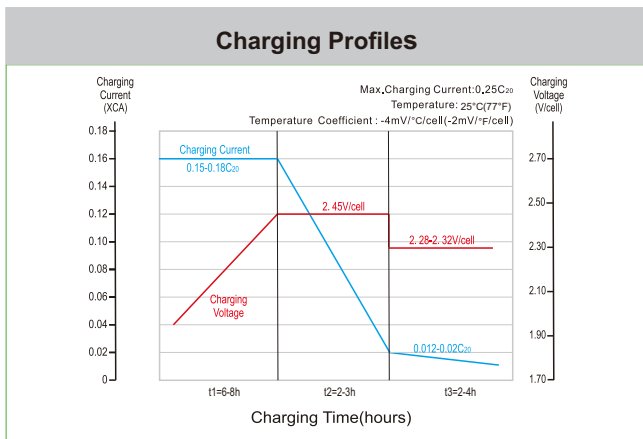

Leoch International Technology Ltd.
www.leoch.com

Leoch Batteries Pte Ltd
www.leoch.sg

Leoch Battery Corporation
www.leochamericas.com

Leoch Europe S.A.
www.leoch.eu