

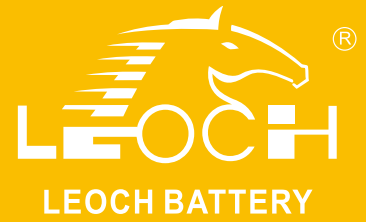

LPL Series-Long Life Standby LPL12-24(12V24Ah)



Specifications

Rated Voltage	12V	
Nominal Capacity	24.0Ah	(C ₂₀ , 1.75V/cell)
Dimension	Length	166±2mm (6.54 inches)
	Width	175±2mm (6.89 inches)
	Container Height	125±2mm (4.92 inches)
	Total Height	125±2mm (4.92 inches)
Approx Weight	7.8 Kg (17.20 lbs)	
Terminal	M5	
Container Material	ABS	
Rated Capacity (25°C)	24.00 Ah	(20hr, 1.20A, 1.75V/cell)
	23.80 Ah	(10hr, 2.38A, 1.75V/cell)
	22.15 Ah	(5hr, 4.43A, 1.75V/cell)
	19.56 Ah	(3hr, 6.52A, 1.75V/cell)
	16.10 Ah	(1hr, 16.1A, 1.60V/cell)
Max. Discharge Current	360A (5s)	
Internal Resistance (25°C)	Approx 14.0mΩ	
Operating Temp. Range	Discharge	-15 ~ 50°C (5 ~ 122°F)
	Charge	0 ~ 40°C (32 ~ 104°F)
	Storage	-15 ~ 40°C (5 ~ 104°F)
Nominal Operating Temp. Range	25±3°C (77±5°F)	
Cycle Use	Initial Charging Current less than 7.2A. Voltage 14.4V~15.0V at 25°C(77°F)Temp. Coefficient -30mV/°C	
	Initial Charging Current less than 7.2A. Voltage 13.5V~13.8V at 25°C(77°F)Temp. Coefficient -20mV/°C	
Standby Use	Initial Charging Current less than 7.2A. Voltage 13.5V~13.8V at 25°C(77°F)Temp. Coefficient -20mV/°C	
Effect of temp. to Capacity	40°C (104°F)	103%
	25°C (77°F)	100%
	0°C (32°F)	86%
Self Discharge	LPL series batteries may be stored for up to 6 months at 25°C(77°F) and then a freshening charge is required. For higher temperatures the time interval will be shorter.	



Layout

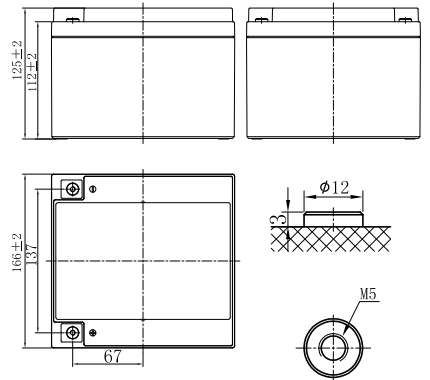

Constant Current Discharge (Amperes) at 25 °C (77°F)

F.V/Time	10min	15min	20min	30min	45min	1h	2h	3h	4h	5h	6h	8h	10h	20h
1.85V/cell	45.9	37.3	31.6	23.8	18.0	14.8	8.46	6.33	5.07	4.32	3.69	2.90	2.33	1.18
1.80V/cell	48.2	38.8	32.6	24.4	18.4	15.0	8.59	6.43	5.15	4.38	3.74	2.94	2.35	1.19
1.75V/cell	50.6	40.2	33.5	25.0	18.8	15.3	8.73	6.52	5.22	4.43	3.79	2.97	2.38	1.20
1.70V/cell	52.9	41.6	34.5	25.5	19.1	15.6	8.86	6.62	5.29	4.49	3.84	3.01	2.41	1.21
1.65V/cell	54.4	42.5	35.1	25.9	19.3	15.7	8.95	6.67	5.33	4.53	3.87	3.03	2.43	1.22
1.60V/cell	57.6	44.4	36.5	26.7	19.9	16.1	9.13	6.81	5.43	4.61	3.94	3.08	2.46	1.24

Constant Power Discharge (Watts/cell) at 25 °C (77°F)

F.V/Time	10min	15min	20min	30min	45min	1h	2h	3h	4h	5h	6h	8h	10h	20h
1.85V/cell	87.8	71.7	60.8	46.0	35.0	28.7	16.6	12.4	10.0	8.52	7.31	5.75	4.62	2.35
1.80V/cell	91.7	74.1	62.4	46.9	35.6	29.1	16.8	12.6	10.1	8.63	7.39	5.82	4.67	2.37
1.75V/cell	95.7	76.4	63.9	47.8	36.1	29.6	17.0	12.8	10.2	8.73	7.47	5.89	4.73	2.40
1.70V/cell	99.6	78.7	65.6	48.7	36.7	30.0	17.2	12.9	10.4	8.83	7.56	5.95	4.78	2.42
1.65V/cell	101.9	80.1	66.5	49.3	37.0	30.2	17.4	13.0	10.4	8.89	7.61	5.99	4.81	2.44
1.60V/cell	107.2	83.2	68.6	50.5	37.8	30.8	17.6	13.2	10.6	9.02	7.73	6.09	4.88	2.47



LPL Series-Long Life Standby LPL12-24(12V24Ah)

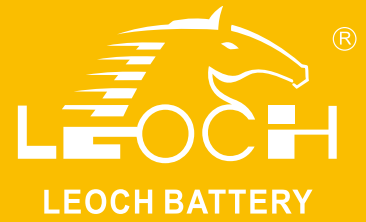

Applications

- UPS and EPS
- Emergency light
- Railway signal and aircraft signal system
- Marine and power stations
- Alarm and security system
- Electronic apparatus and equipment
- Communication power supply, DC power supply

General Features

- 10 ~ 12 years design life(20°C)
- Grid refining technology and the thicker plates are used to extend the battery standby life and reduce the plate grid corrosion speed
- Using oxygen recombination technology: maintenance-free
- Unique vent valve design: control water losing, prevent air and spark going inside

Standards

- Compliance with IEC 60896 standards, EU Battery Directive
- UL, CE Certified
- Manufactured in Leoch@IATF16949, OHSAS 18001, ISO 9001 and ISO 14001 certified production facilities

Discharge Characteristics

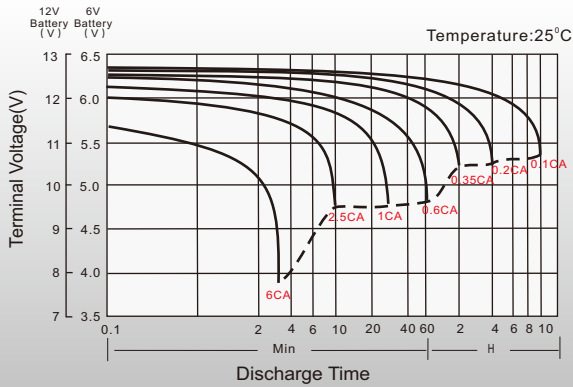

Float Charging Characteristics

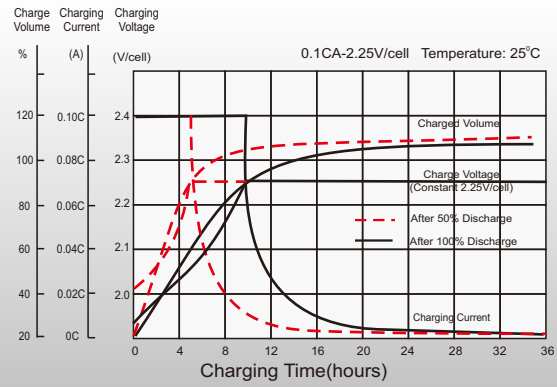

Temperature Effects in Relation to Battery Capacity

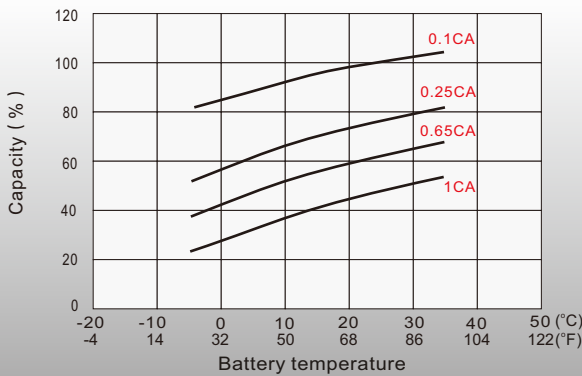

Float Service Life

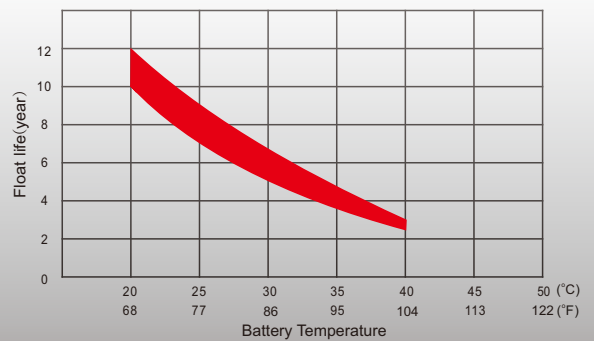

Sales Offices Worldwide

China Sales Office

5th Floor, Xinbaohui Bldg., Nanhai Blvd.,
Nanshan, Shenzhen, China. 518052
Tel: +86-755-86036060 (100 lines)
Fax: +86-755-26067269
E-mail: export@leoch.com

HongKong Sales Office

Workshop C, 33/F, TML Tower, No. 3 Hoi Shing Road,
Tsuen Wan, New Territories, Hong Kong
Tel: +852 35786666
Fax: +44 1452 690125
E-mail: sales.hk@leoch.com

Singapore Sales Office

No. 1 Tech Park Crescent,
Singapore 638131
Tel: +65 68636078
Fax: +65 6863 6079
Email: sales.sg@Leoch.com

Australia Sales Office

2 /29 Tarlington Place, Smithfield. NSW 2164
Australia
Tel: 02 9756 0950
E-mail: sales.au@leoch.com

North America Sales Office

19751 Descartes
Foothill Ranch, CA 92610, USA
Tel: 949-588-5853
Fax: 949-588-5966
E-mail: sales@leoch.us

UK Sales Office

9B Wheatstone Court. Waterwells, Business Park,
Gloucester, GL2-2AQ, UK United Kingdom
Tel: +44(0) 1452 729428 / 1452 729696
Fax: +44 1452 690125
E-mail: Sales.Europe@leoch.com

EMEA Sales Office

1 Deligiorgi St., 121 31 Athens,
Greece
Tel: +30 210 5760318 (2 lines)
E-mail: support_EMEA@leoch.com

India Sales Office

Shed no.A-53(b), 2nd Stage of Peenya Industrial Area,
Bangalore North Taluk, Bangalore-560058, India
Tel: +91-80-23440018/23440019
Fax: +91-80-23440017
E-mail: indiasales@leoch.com



[Http://www.leoch.com](http://www.leoch.com)
[Http://www.leoch.us](http://www.leoch.us)

© 2018 LEOCH. All rights reserved.
Trademarks and logos are the property of LEOCH and its affiliates unless otherwise noted.
Subject to revisions without prior notice.

Publication No.: LB-LPL12-24-PD-EN-V2.0-201904