

# LRC SERIES-LEAD CARBON

## LRC2-1000 (2V1000Ah)

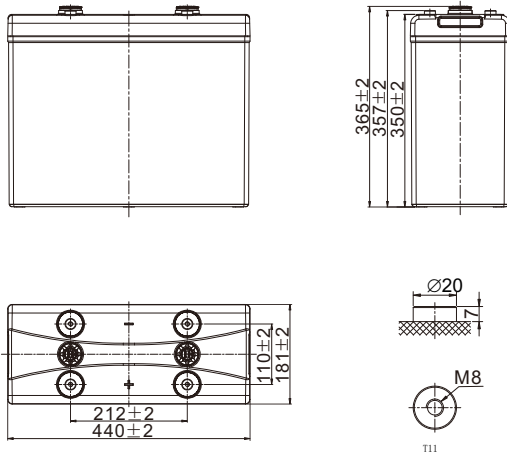

### CHARACTERISTICS

Item	Specifications	
Rated Voltage	2V	
Nominal Capacity (25°C)	C <sub>10</sub> , 1.80V/cell	1000Ah
Dimension	Length	440mm (17.3inches)
	Width	181mm (7.13inches)
	Container Height	350mm (13.8inches)
	Total Height	365mm (14.4inches)
Approx Weight	75.8kg (167.1lbs)	
Terminal	T11(M8)	
Container Material	ABS (UL94 HB or V-0 optional)	
Short-circuit current	11000A	
Internal Resistance (25°C)	Approx 0.23 mΩ (Fully charged)	
Operating Temp. Range	Discharge	-20~55°C (-4~131°F)
	Charge	-20~40°C (-4~104°F)
	Storage	-20~50°C (-4~122°F)
Nominal Operating Temp. Range	25±3°C (77±5°F)	
Max.Charging Current (25°C)	0.3C	
Charge voltage (25°C)	Standby Use	Cycle Use
	/	2.35-2.40V/cell
Temp. Coefficient	/	-5mV/cell/°C
	40°C (104°F)	103%
Effect of temp. to Capacity	25°C (77°F)	100%
	0°C (32°F)	86%
	Self Discharge	≤3.5% per month at 25°C (77°F)

### DISCHARGE TABLE

Constant Current Discharge (Amperes) at 25°C (77°F)																		
F.V/Time	1h	2h	3h	4h	5h	6h	8h	10h	24h	36h	48h	60h	72h	84h	96h	108h	120h	240h
1.90V/cell	395.2	274.1	207.5	176.9	148.0	128.2	103.9	89.3	44.1	29.9	22.9	/	/	/	/	/	/	5.50
1.85V/cell	428.0	294.0	228.4	189.1	158.8	138.0	112.4	97.1	48.0	32.5	25.0	20.0	17.0	14.8	13.0	12.0	10.9	/
1.80V/cell	512.4	311.2	250.0	195.7	164.2	142.5	116.0	100.0	49.0	33.2	25.5	/	/	/	/	/	/	/
1.75V/cell	550.0	325.4	257.9	200.4	167.9	145.7	118.3	101.9	50.0	33.8	26.0	/	/	/	/	/	/	/

Constant Power Discharge (Watts/cell) at 25°C (77°F)																		
F.V/Time	1h	2h	3h	4h	5h	6h	8h	10h	24h	36h	48h	60h	72h	84h	96h	108h	120h	240h
1.90V/cell	774.5	543.4	416.8	356.7	299.0	259.5	210.9	181.7	86.2	58.4	44.8	/	/	/	/	/	/	11.0
1.85V/cell	841.0	574.8	454.1	377.3	317.3	276.0	225.4	195.0	90.2	61.0	46.9	40.0	34.0	29.6	26.0	24.0	21.8	/
1.80V/cell	988.0	604.3	491.5	390.5	328.3	285.6	233.2	201.7	93.1	63.0	48.4	/	/	/	/	/	/	/
1.75V/cell	1039.4	628.1	503.7	397.0	333.4	289.7	236.1	203.9	95.1	64.4	49.4	/	/	/	/	/	/	/

# LRC SERIES-LEAD CARBON

## LRC2-1000 (2V1000Ah)



### APPLICATIONS

- Mobile container storage system
- Peak load shifting energy storage system
- Oil and electricity hybrid energy storage system
- Grid frequency adjustment energy storage system
- New energy communication base station, IDC, UPS etc.
- New energy generation (solar, wind, PV/wind hybrid) access to energy storage systems

### GENERAL FEATURES

- Super Carbon technology enhanced active material to maximize cycle performance and PSoC operation
- 100% leak tested to ensure seal integrity
- High-strength, High Temperature resistant, UL94-V0 Compliant Case and Cover optional
- Extended service life in high temperature applications
- Modular design and installation for less space, easy installation and maintenance

### STANDARDS

- Compliance with IEC 61427, BS EN 61427 standards
- UL, CE Approved
- Manufactured in Leoch@IATF16949, ISO 45001, ISO 9001 and ISO 14001 certified production facilities

#### Discharge Characteristics

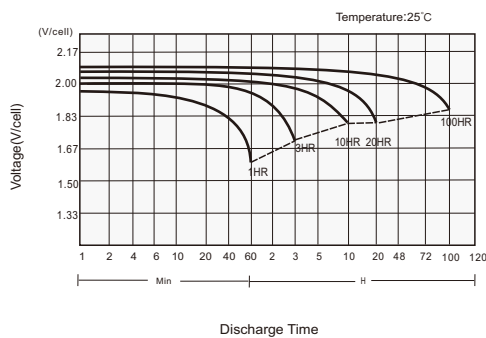

#### Charging Characteristics

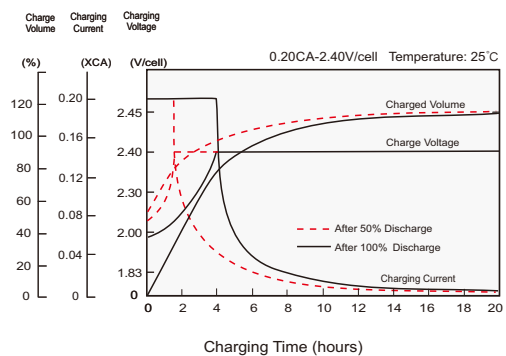

#### Cycle Life in Relation to DoD

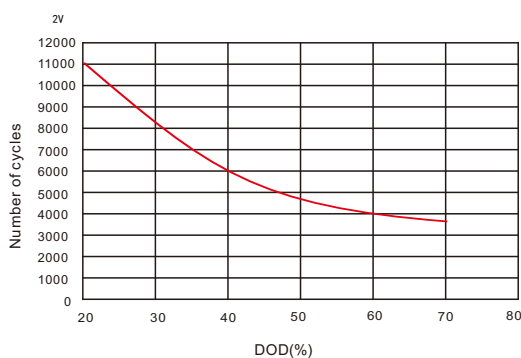

#### Self Discharge Characteristics

