

FLOODED BATTERY

31T-950 (12V105Ah)



CHARACTERISTICS

Item	Specifications
Nominal Voltage	12V
Nominal Capacity (20HR)	105Ah
Reserve Capacity	190min
Cold Cranking Amps@0°F (-18°C)	950A
Dimension	Length
	329mm (13.0inches)
	Width
Dimension	171mm (6.73inches)
	Height
Dimension	237mm (9.33inches)
	Approx Weight
Terminal	25.7kg (56.7lbs)
	13
Cell layout	8
Hold-Down	B0
Case	Black-PP Material
Cover	Black-PP Material
Handle	TS9

APPLICATIONS

- Car start
- EV/HEV
- Engine start

GENERAL FEATURES

- High capacity and high CCA
- Long life
- Advanced lead-calcium alloy technology, maintenance-free design
- Patented venting system bring less water loss and prevent acid leakage
- OE quality certification

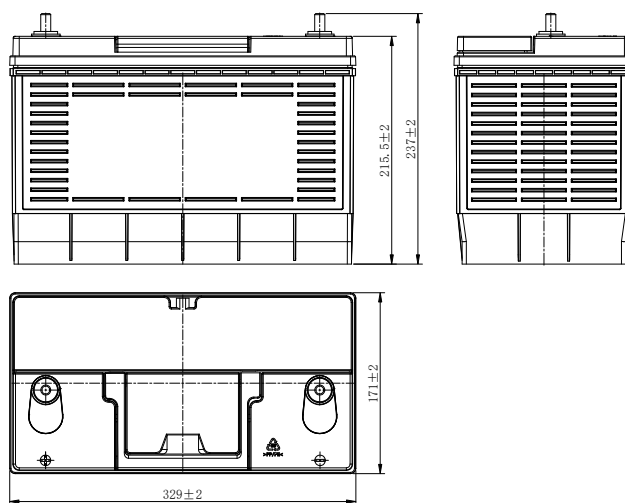
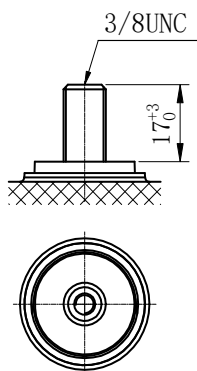

*Values are subject to variation of +/- 5% in normal manufacturing processes.

Leoch International Technology Ltd.
www.leoch.com

Leoch Batteries Pte Ltd
www.leoch.sg

Leoch Battery Corporation
www.leochamericas.com

Leoch Europe S.A.
www.leoch.eu