

FLOODED BATTERY

78-570 (12V65Ah)



CHARACTERISTICS

Item	Specifications
Nominal Voltage	12V
Nominal Capacity (20HR)	65Ah
Reserve Capacity	108min
Cold Cranking Amps@0°F (-18°C)	570A
Dimension	Length
	268mm (10.6inches)
	Width
Dimension	180mm (7.09inches)
	Height
Dimension	182mm (7.17inches)
	Approx Weight
Terminal	16.2kg (35.7lbs)
	20
Cell layout	6
Hold-Down	B01
Case	Black-PP Material
Cover	Black-PP Material
Handle	TS5

APPLICATIONS

- Car start
- EV/HEV
- Engine start

GENERAL FEATURES

- High capacity and high CCA
- Long life
- Advanced lead-calcium alloy technology, maintenance-free design
- Patented venting system bring less water loss and prevent acid leakage
- OE quality certification

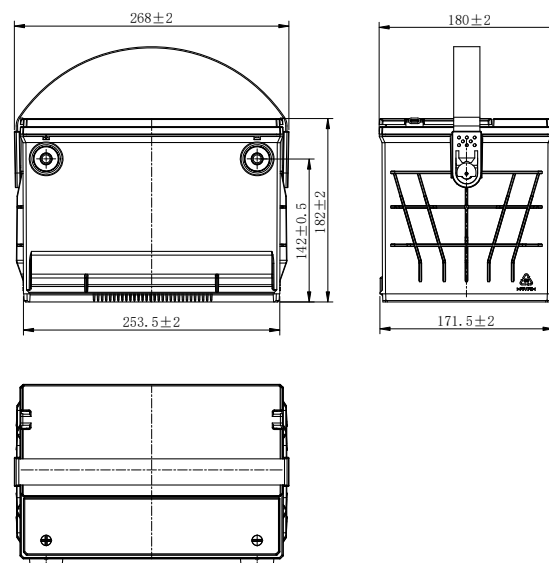
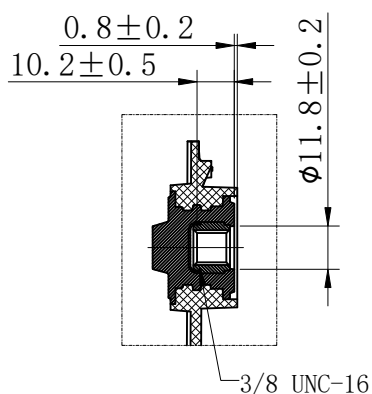

*Values are subject to variation of +/- 5% in normal manufacturing processes.

Leoch International Technology Ltd.
www.leoch.com

Leoch Batteries Pte Ltd
www.leoch.sg

Leoch Battery Corporation
www.leochamericas.com

Leoch Europe S.A.
www.leoch.eu