

# FLOODED HIGH TEMPERATURE BATTERY

180H52RHT (12V190Ah)



## CHARACTERISTICS

Item	Specifications	
Nominal Voltage	12V	
Nominal Capacity (20HR)	190Ah	
Reserve Capacity	383min	
Cold Cranking Amps@0°F (-18°C)	1050A	
Dimension	Length	521mm (20.5inches)
	Width	261mm (10.3inches)
	Container Height	217.5mm (8.56inches)
	Total Height (with Terminal)	250mm (9.84inches)
Approx Weight	54.5kg (120.2lbs)	
Terminal	4	
Cell layout	3	
Hold-Down	B0	
Case	Black-PP Material	
Cover	Black-PP Material	
Handle	TS8	

## APPLICATIONS

- Car start
- EV/HEV
- Engine start

## GENERAL FEATURES

- Design for high temperature countries and regions
- Superior life in high temperature environment
- High tin alloy and thicker positive grid
- High-temp paste
- Patented venting system bring less water loss and prevent acid leakage

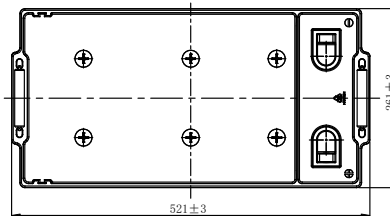
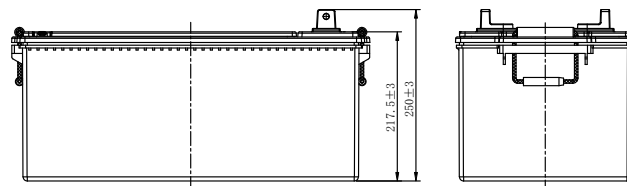
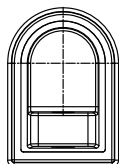
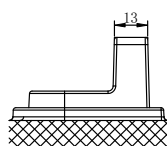
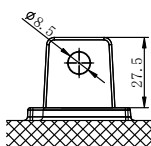

\*Values are subject to variation of +/- 5% in normal manufacturing processes.

Leoch International Technology Ltd.  
[www.leoch.com](http://www.leoch.com)

Leoch Batteries Pte Ltd  
[www.leoch.sg](http://www.leoch.sg)

Leoch Battery Corporation  
[www.leochamericas.com](http://www.leochamericas.com)

Leoch Europe S.A.  
[www.leoch.eu](http://www.leoch.eu)