



LEOCH BATTERY

6-QW-55(480)-L (12V55Ah)



Dimensions (mm)

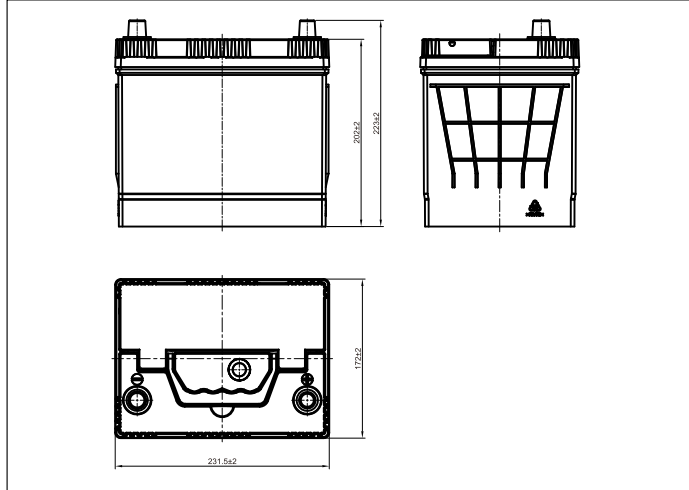

Physical Specification (mm)

Nominal Voltage		12V
Nominal Capacity(20HR)		55Ah
Dimension	Length	231.5±2mm(9.11inches)
	Width	172±2mm(6.77inches)
	Container Height	202±2mm(7.95inches)
	Total Height(with Terminal)	223±2mm(8.78inches)
Weight		Approx 14.7Kg(32.41lbs)
Acid		1.280±0.015g/cm ³ (25°C)
Standard Terminal		1
Cell layout		0
Hold-Down		B0
Cell plate qty		/
Case		Black-PP Material
Cover		Black-PP Material
Handle		Black-PP Material
QTY/PLT/layer		/

Electrical Specification

Rated Capacity	20 hour rate(2.75A)	55Ah
Reserve Capacity		88min
Cold Cranking Performance Amps@0°F(-18°C)		480A

Discharge Characteristics(25°C,70°F)

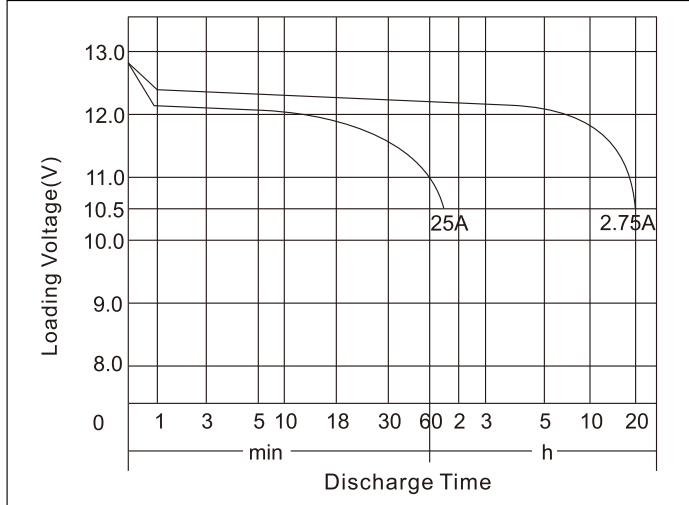

Standard Terminal (mm) / Cell Layout

Terminal Type	D		Cell Layout
	Positive	Negative	
1	19.5 ⁰ _{-0.3}	17.9 ⁰ _{-0.3}	

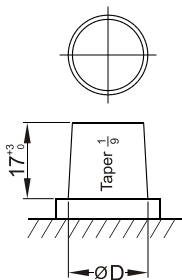

Figure(0)

Discharge Characteristics(-18°C,0°F)

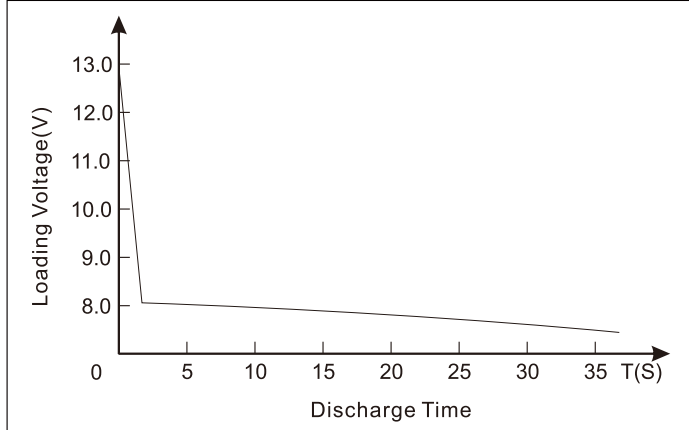

*Values are subject to variation of +/- 5% in normal manufacturing processes.
*Technical specifications and the product line above could be changed without prior notice.