

EBZ14-4-1 (12V11.2Ah)

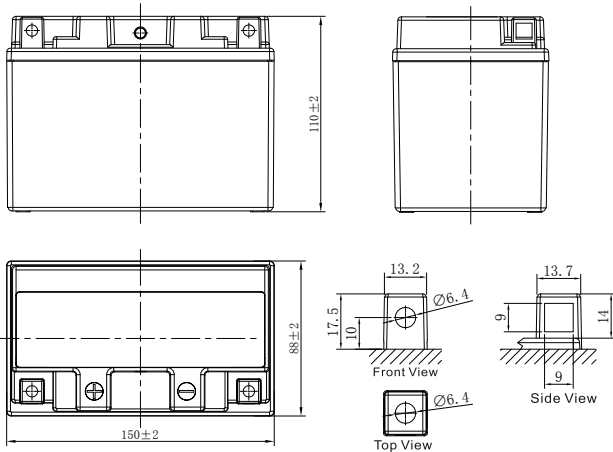

GENERAL FEATURES

- Maintenance-free
- Sealed and non-spillable AGM battery
- Shipped pre-charged and ready to install

CHARACTERISTICS

Item	Specifications	
Nominal Voltage	12V	
Nominal Capacity (10HR)	11.2Ah	
Cold Cranking Performance Amps@0°F (-18°C)	210A	
Dimension (±2mm)	Length	150mm (5.91inches)
	Width	88mm (3.46inches)
	Container Height	110mm (4.33inches)
	Total Height	110mm (4.33inches)
Battery (with acid)	Approx Weight	3.83kg (8.44lbs)
Terminal type	A	
Battery type	Factory Activated Series	
Full Charge	Constant-Voltage Charge:	
	Initial charging current	Less than 0.3C ₁₀
	Voltage	14.40V~15.00V at 25°C (77°F)
	Charging time	15~18h
	Constant-Current Charge:	
	Charging current 0.1C ₁₀ , when charging voltage up to 14.40V, continue to charge 4h	
	Floating Charge	Initial charging current
Capacity affected by Temperature	Voltage	13.50V~13.80V at 25°C (77°F)
	40°C (104°F)	106%
	25°C (77°F)	100%
	0°C (32°F)	86%
	-15°C (5°F)	65%

Discharge Characteristics (25°C, 77°F)

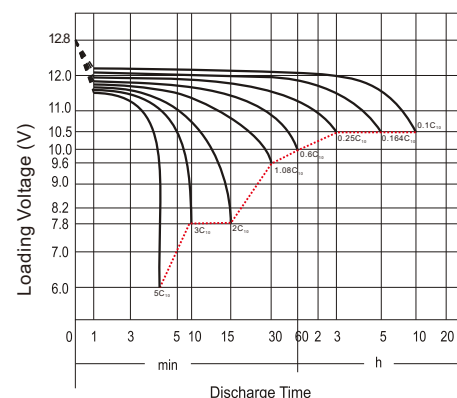

*Values are subject to variation of +/- 5% in normal manufacturing processes.

Leoch International Technology Ltd.
 www.leoch.com

Leoch Batteries Pte Ltd
 www.leoch.sg

Leoch Battery Corporation
 www.leochamericas.com

Leoch Europe S.A.
 www.leoch.eu

Data above is recommended and the picture is only for battery effect display, Leoch reserve the final right of explanation.
© LEOCH. All rights reserved. Trademarks and logos are the property of LEOCH and its affiliates unless otherwise noted. Subject to revisions without prior notice. E&OE.

Publication No.:LB-EBZ14-4-1-PD-EN-V1.0-20230804