

# MAINTENANCE-FREE MOTORCYCLE BATTERY

EBZ6.5-3 (12V6.5Ah)

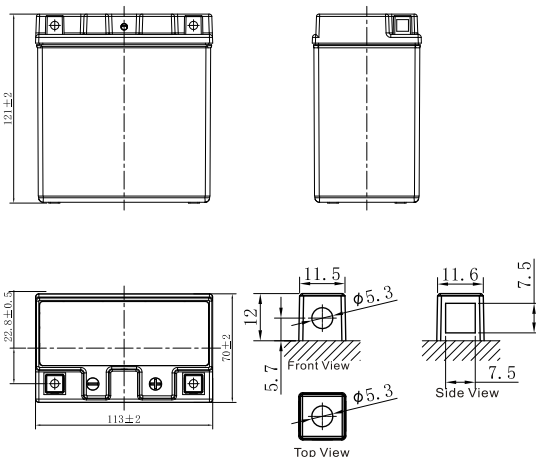

## GENERAL FEATURES

- Maintenance-free
- Sealed and non-spillable AGM battery
- Shipped pre-charged and ready to install

\*Values are subject to variation of +/- 5% in normal manufacturing processes.

## CHARACTERISTICS

Item	Specifications
Nominal Voltage	12V
Nominal Capacity (10HR)	6.5Ah
Cold Cranking Performance Amps@0°F (-18°C)	105A
Dimension (±2mm)	Length 113mm (4.45inches)
	Width 70mm (2.76inches)
	Container Height 121mm (4.76inches)
	Total Height 121mm (4.76inches)
Battery (with acid)	Approx Weight 2.34kg (5.16lbs)
Terminal type	A
Battery type	Factory Activated Series
Full Charge	Constant-Voltage Charge:
	Initial charging current Less than 0.3C <sub>10</sub>
	Voltage 14.40V~15.00V at 25°C (77°F)
	Charging time 15~18h
	Constant-Current Charge:
	Charging current 0.1C <sub>10</sub> , when charging voltage up to 14.40V, continue to charge 4h
Floating Charge	Initial charging current Unlimited
	Voltage 13.50V~13.80V at 25°C (77°F)
Capacity affected by Temperature	40°C (104°F) 106%
	25°C (77°F) 100%
	0°C (32°F) 86%
	-15°C (5°F) 65%

## Discharge Characteristics (25°C, 77°F)

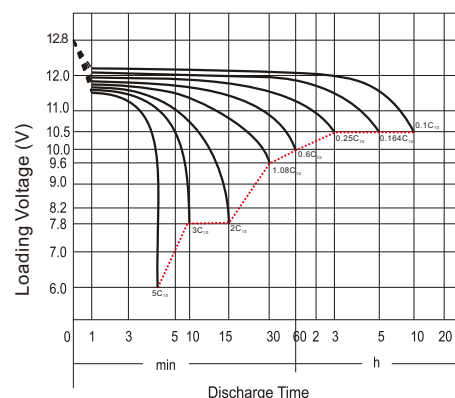

Leoch International Technology Ltd.  
www.leoch.com

Leoch Batteries Pte Ltd  
www.leoch.sg

Leoch Battery Corporation  
www.leochamericas.com

Leoch Europe S.A.  
www.leoch.eu