

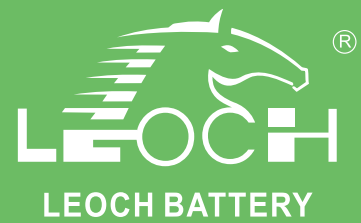

# LPGS Series-Gel Battery

## LPGS12-230(12V230Ah)



### Specifications

Rated Voltage	12V	
Nominal Capacity	230Ah (C <sub>20</sub> , 1.75V/cell)	
Dimension	Length	522±3mm (20.6 inches)
	Width	268±3mm (10.6 inches)
	Container Height	220±3mm (8.66 inches)
	Total Height	226±3mm (8.90 inches)
Approx Weight	73.6 Kg (162.3 lbs)	
Terminal	M8	
Container Material	ABS	
Rated Capacity (25°C)	247.0 Ah	(100hr, 2.47A, 1.80V/cell)
	244.1 Ah	(72hr, 3.39A, 1.80V/cell)
	230.0 Ah	(20hr, 11.5A, 1.75V/cell)
	209.0 Ah	(10hr, 20.9A, 1.80V/cell)
	138.2 Ah	(1hr, 138.2A, 1.75V/cell)
Max. Discharge Current	2090A (5s)	
Internal Resistance (25°C)	Approx 2.9mΩ	
Operating Temp. Range	Discharge : -20 ~ 55°C (-4 ~ 131°F)	
	Charge : 0 ~ 40°C (32 ~ 104°F)	
	Storage : -20 ~ 50°C (-4 ~ 122°F)	
Nominal Operating Temp. Range	25±3°C (77±5°F)	
Cycle Use	Initial Charging Current less than 52.3A. Voltage 14.1V~14.4V at 25°C(77°F)Temp. Coefficient -30mV/°C	
	Standby Use	
Effect of temp. to Capacity	Initial Charging Current less than 52.3A. Voltage 13.5V~13.8V at 25°C(77°F)Temp. Coefficient -20mV/°C	
	40°C (104°F)	103%
	25°C (77°F)	100%
Self Discharge	0°C (32°F)	86%
	LPGS series batteries may be stored for up to 6 months at 25°C(77°F) and then a freshening charge is required. For higher temperatures the time interval will be shorter.	

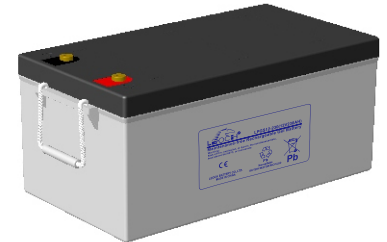

### Layout

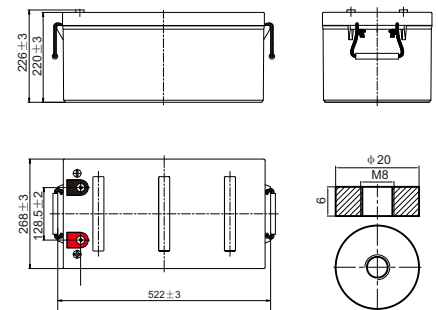

### Constant Current Discharge (Amperes) at 25 °C (77°F)

F.V/Time	1h	2h	3h	4h	5h	6h	8h	10h	20h	48h	72h	100h
1.90V/cell	101.8	64.2	49.0	40.1	33.8	29.1	22.7	18.6	9.98	4.45	3.02	2.19
1.85V/cell	121.7	71.9	53.8	43.7	36.8	31.7	24.7	20.4	10.9	4.81	3.28	2.39
1.80V/cell	131.6	75.8	56.4	45.3	38.1	32.7	25.5	20.9	11.2	4.96	3.39	2.47
1.75V/cell	138.2	79.1	58.2	46.7	38.9	33.4	26.0	21.4	11.5	5.04	3.44	2.52

### Constant Power Discharge (Watts/cell) at 25 °C (77°F)

F.V/Time	1h	2h	3h	4h	5h	6h	8h	10h	20h	48h	72h	100h
1.90V/cell	199.3	126.5	97.4	79.9	67.9	58.4	45.4	37.3	19.9	8.90	6.04	4.37
1.85V/cell	235.9	140.4	105.9	86.4	73.3	63.0	49.2	40.6	21.9	9.63	6.57	4.81
1.80V/cell	252.5	146.9	110.4	86.8	75.3	64.7	50.7	41.6	22.4	9.89	6.77	4.95
1.75V/cell	264.5	152.7	113.6	91.4	76.6	65.9	51.4	42.3	22.9	10.1	6.88	5.04



# LPGS Series-Gel Battery

## LPGS12-230(12V230Ah)

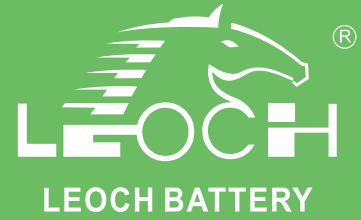

### Applications

- Solar energy (wind energy) household system /communication / communication base station;
- Movable energy storage system;
- Solar traffic lights;
- Solar, wind and solar power generation;
- Emergency lighting system.

### General Features

- Adopted advantage AGM-GEL technology
- Operation temperature -20~55°C
- ≤3% Self discharge per month
- Fast recharge

### Standards

- IEC 60896 Certified
- Classified as "Long Life" according to Eurobat
- Manufactured in Leoch® IATF16949, ISO 9001, ISO 14001 and ISO 45001 certified production facilities

### Temperature Effects in Relation to Battery Capacity

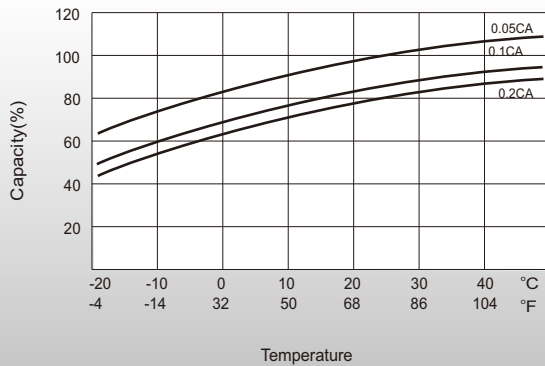

### Charging Characteristics

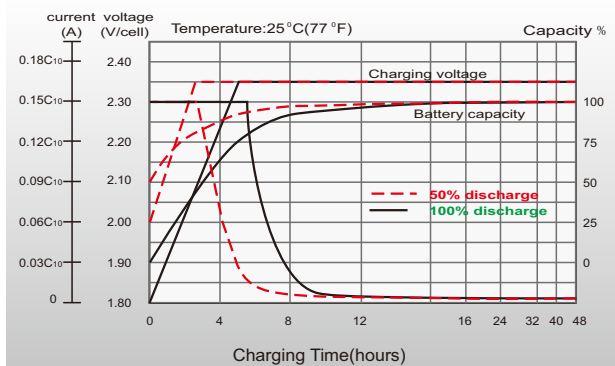

### Cycle Life in Relation to Depth of Discharge

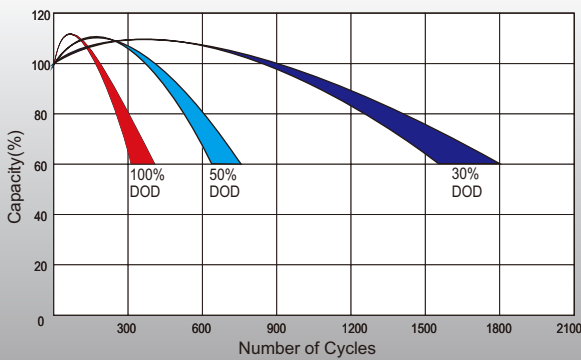

### Self Discharge Characteristics

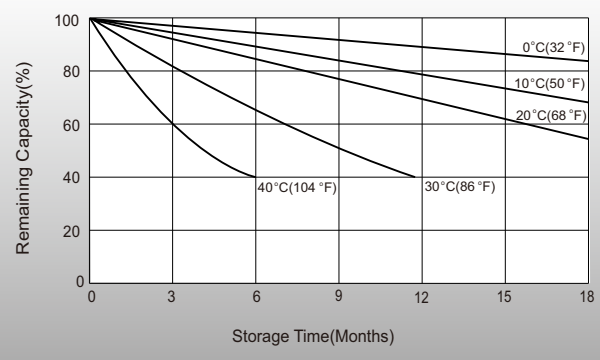

### Sales Offices Worldwide

#### China Sales Office

5th Floor, Xinbaohui Bldg., Nanhai Blvd.,  
Nanshan, Shenzhen, China. 518052  
Tel: +86-755-86036060 (100 lines)  
Fax: +86-755-26067269  
E-mail: export@leoch.com

#### HongKong Sales Office

Workshop C, 33/F, TML Tower, No. 3 Hoi Shing Road,  
Tsuen Wan, New Territories, Hong Kong  
Tel: +852 35786666  
Fax: +44 1452 690125  
E-mail: sales.hk@leoch.com

#### Singapore Sales Office

No. 1 Tech Park Crescent,  
Singapore 638131  
Tel: +65 68636078  
Fax: +65 6863 6079  
Email: sales.sg@Leoch.com

#### Australia Sales Office

2/29 Tarlington Place, Smithfield. NSW 2164  
Australia  
Tel: 02 9756 0950  
E-mail: sales.au@leoch.com

#### North America Sales Office

19751 Descartes  
Foothill Ranch, CA 92610, USA  
Tel: 949-588-5853  
Fax: 949-588-5966  
E-mail: sales@leoch.us  
Http://www.leoch.us

#### UK Sales Office

9B Wheatstone Court, Waterwells, Business Park,  
Gloucester, GL2-2AQ, UK United Kingdom  
Tel: +44(0) 1452 729428 / 1452 729696  
Fax: +44 1452 690125  
E-mail: Sales.Europe@leoch.com  
Http://www.leoch.eu

#### EMEA Sales Office

1 Deligiorgi St., 121 31 Athens,  
Greece  
Tel: +30 210 5760318 (2 lines)  
E-mail: support\_EMEA@leoch.com  
Http://www.leoch.eu

#### India Sales Office

Shed no. A-53(b), 2nd Stage of Peenya Industrial Area,  
Bangalore North Taluk, Bangalore-560058, India  
Tel: +91-80-23440018/23440019  
Fax: +91-80-23440017  
E-mail: indiasales@leoch.com



[Http://www.leoch.com](http://www.leoch.com)

© 2019 LEOCH. All rights reserved.

Trademarks and logos are the property of LEOCH and its affiliates unless otherwise noted.  
Subject to revisions without prior notice.

Publication No.: LB-LPGS12-230-PD-EN-V2.2-202004