

# LPG SERIES-GEL BATTERY

## LPG2-800 (2V800Ah)

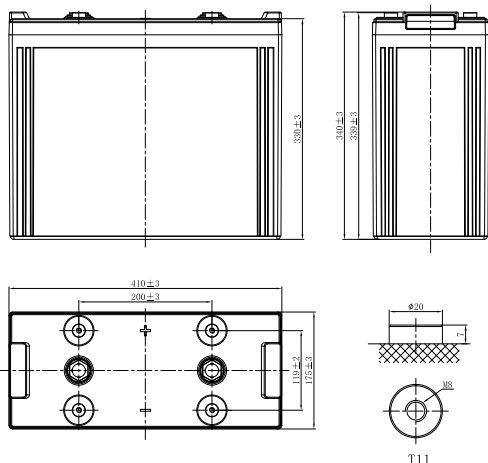

### CHARACTERISTICS

Item	Specifications	
Rated Voltage	2V	
Nominal Capacity (25°C)	C <sub>10</sub> , 1.80V/cell	800Ah
Dimension	Length	410mm (16.1inches)
	Width	175mm (6.89inches)
	Container Height	330mm (13.0inches)
	Total Height	340mm (13.4inches)
Approx Weight	54.0kg (119.0lbs)	
Terminal	T11(M8)	
Container Material	ABS (UL94 HB or V-0 optional)	
Short-circuit current	7200A	
Internal Resistance (25°C)	Approx 0.5 mΩ (Fully charged)	
Operating Temp. Range	Discharge	-20~60°C (-4~140°F)
	Charge	-20~40°C (-4~104°F)
	Storage	-20~50°C (-4~122°F)
Nominal Operating Temp. Range	25±3°C (77±5°F)	
Max.Charging Current (25°C)	0.25C	
Charge voltage (25°C)	Standby Use	Cycle Use
	2.23-2.27V/cell	2.35-2.40V/cell
Temp. Coefficient	-3mV/cell/°C	
	-5mV/cell/°C	
Effect of temp. to Capacity	40°C (104°F)	103%
	25°C (77°F)	100%
	0°C (32°F)	86%
Self Discharge	≤2.5% per month at 25°C (77°F). LPG series batteries may be stored up to 9 months at 25°C (77°F) and then a freshening charge is required. For higher temperatures the time interval will be shorter.	

### DISCHARGE TABLE

Constant Current Discharge (Amperes) at 25°C (77°F)												
F.V/Time	30min	45min	1h	1.5h	2h	3h	4h	5h	6h	8h	10h	20h
1.85V/cell	450.4	397.8	368.2	271.5	224.6	185.1	148.9	127.3	109.1	89.0	75.0	40.2
1.80V/cell	503.6	440.3	402.8	296.3	245.2	200.3	160.5	137.1	117.0	95.3	80.0	42.4
1.75V/cell	524.1	456.5	416.4	305.9	253.1	205.6	164.5	140.1	119.4	97.0	81.2	42.9
1.70V/cell	544.0	473.3	430.4	315.9	261.4	211.6	168.6	143.4	122.0	98.8	82.5	43.5
1.67V/cell	556.2	483.2	438.1	321.4	265.9	214.8	171.0	145.1	123.5	99.8	83.2	43.8
1.60V/cell	584.9	506.7	457.7	335.4	277.5	222.7	176.6	149.6	126.9	102.1	85.0	44.6
Constant Power Discharge (Watts/cell) at 25°C (77°F)												
F.V/Time	30min	45min	1h	1.5h	2h	3h	4h	5h	6h	8h	10h	20h
1.85V/cell	873.3	773.3	717.8	529.9	438.3	362.9	292.5	250.5	215.0	175.9	148.4	79.9
1.80V/cell	969.3	850.0	780.9	575.2	475.8	391.0	314.2	269.0	230.1	187.9	158.1	84.2
1.75V/cell	1001.0	875.2	802.2	590.3	488.3	399.7	320.9	274.3	234.2	191.0	160.3	85.2
1.70V/cell	1030.8	901.1	824.4	606.3	501.6	409.5	327.8	279.7	238.7	193.9	162.5	86.2
1.67V/cell	1048.7	915.5	836.1	614.7	508.5	414.6	331.5	282.5	241.1	195.7	163.8	86.8
1.60V/cell	1091.2	951.0	866.2	636.2	526.3	427.3	340.8	290.0	246.8	199.7	166.8	88.3

# LPG SERIES-GEL BATTERY

## LPG2-800 (2V800Ah)



### APPLICATIONS

- Telecommunications
- Solar system
- Wind power system
- Engine starting
- Wheelchair, Floor cleaning machines, Golf trolley, Boats

### GENERAL FEATURES

- 16 years design life (25°C)
- Gelled electrolyte for superior thermal management, long float life
- Efficient gas recombination decreases gassing/water and extends battery life
- Robust design - resilient in harsh conditions
- Proof against deep discharge - greater long-term energy delivery and cycle life

### STANDARDS

- IEC60896 Certified
- Classified as "Very Long Life" according to Eurobat
- UL, CE Approved
- Manufactured in Leoch@IATF16949, ISO 45001, ISO 9001 and ISO 14001 certified production facilities

#### Discharge Characteristics

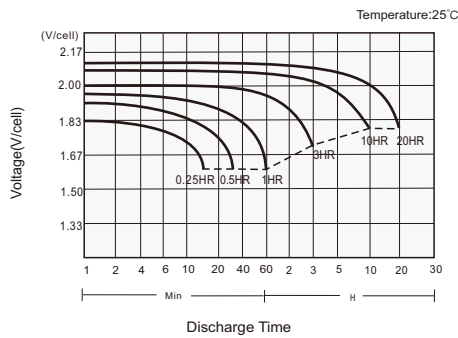

#### Charging Characteristics

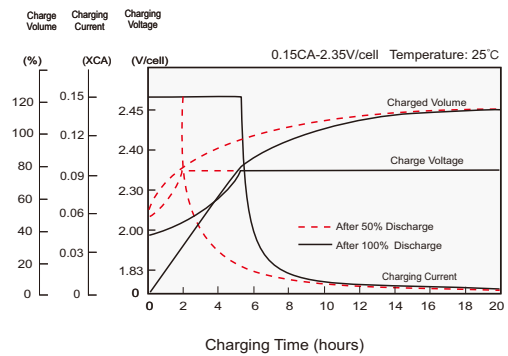

#### Cycle Life in Relation to DoD

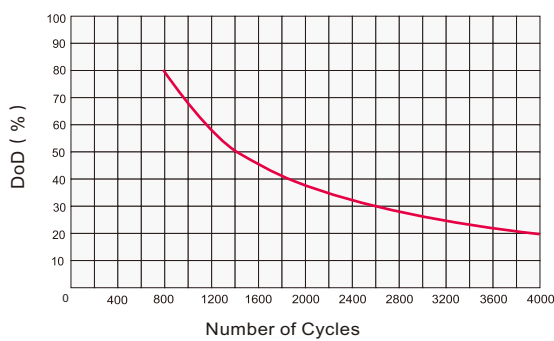

#### Self Discharge Characteristics

