

AUXILIARY BATTERY

EB14D-4 (12V14Ah)



CHARACTERISTICS

| Item | Specifications | |
|--------------------------------|-------------------|--------------------|
| Nominal Voltage | 12V | |
| Nominal Capacity (20HR) | 14Ah | |
| Cold Cranking Amps@0°F (-18°C) | 200A | |
| Dimension | Length | 150mm (5.91inches) |
| | Width | 87mm (3.43inches) |
| | Height | 145mm (5.71inches) |
| Approx Weight | 4.76kg (10.5lbs) | |
| Terminal | O | |
| Cell layout | 1 | |
| Hold-Down | B0 | |
| Case | Black-PP Material | |
| Cover | Black-PP Material | |
| Handle | / | |

APPLICATIONS

- High-end car auxiliary
- Safety assistant

GENERAL FEATURES

- VRLA technology with long life
- Modified PP material case and cover, with high strength and impact resistance
- Top-level safety - absolutely no free acid
- Absorb the instantaneous overvoltage in the vehicle circuit, protect the vehicle circuit from damage
- Uninterruptible power supply for safety components and escort for safety during driving
- OE quality certification

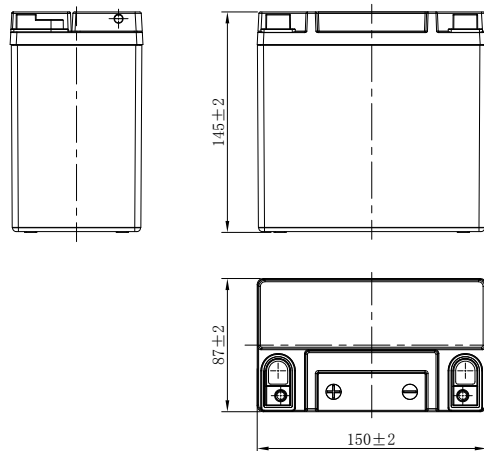
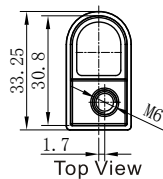
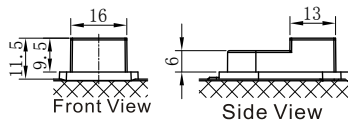

*Values are subject to variation of +/- 5% in normal manufacturing processes.

Leoch International Technology Ltd.
www.leoch.com

Leoch Batteries Pte Ltd
www.leoch.sg

Leoch Battery Corporation
www.leochamericas.com

Leoch Europe S.A.
www.leoch.eu