

FLOODED BATTERY

55D23L (12V60Ah)



CHARACTERISTICS

Item	Specifications	
Nominal Voltage	12V	
Nominal Capacity (20HR)	60Ah	
Reserve Capacity	98min	
Cold Cranking Amps@0°F (-18°C)	520A	
Dimension	Length	231.5mm(9.11inches)
	Width	174.5mm(6.87inches)
	Height	223mm(8.78inches)
Approx Weight	15.2kg(33.5lbs)	
Terminal	1	
Cell layout	0	
Hold-Down	B1	
Case	Black-PP Material	
Cover	Black-PP Material	
Handle	TS1	

APPLICATIONS

- Car start
- EV/HEV
- Engine start

GENERAL FEATURES

- High capacity and high CCA
- Long life
- Advanced lead-calcium alloy technology, maintenance-free design
- Patented venting system bring less water loss and prevent acid leakage
- OE quality certification

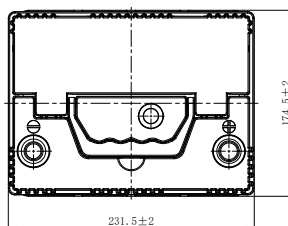
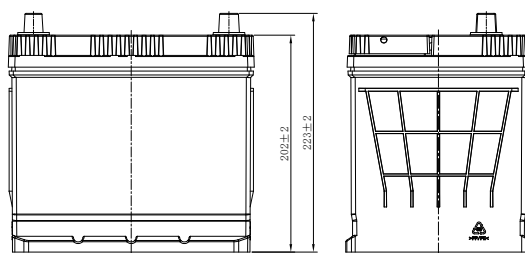
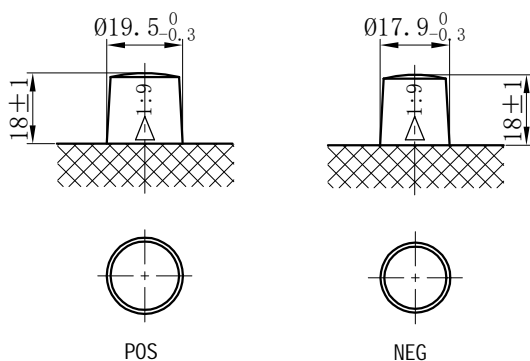

*Values are subject to variation of +/- 5% in normal manufacturing processes.

Leoch International Technology Ltd.



www.leoch.com

Leoch Batteries Pte Ltd



www.leoch.sg

Leoch Battery Corporation



www.leochamericas.com

Leoch Europe S.A.



www.leoch.eu