



# LEOCH<sup>®</sup>

## AGM-L1 (12V50Ah)



### Dimensions (mm)

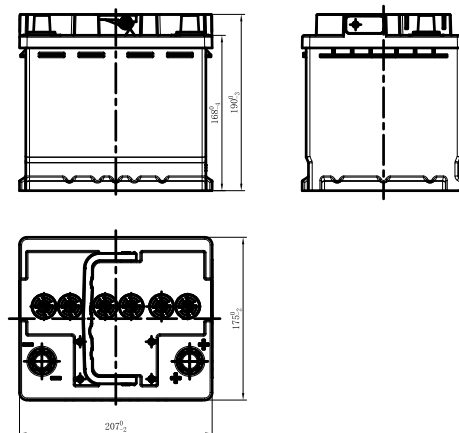

### Physical Specification (mm)

Nominal Voltage		12V
Nominal Capacity(20HR)		50Ah
Dimension	Length	207+0/-2mm(8.15inches)
	Width	175+0/-2mm(6.89inches)
	Container Height	190+0/-3mm(7.48inches)
	Total Height(with Terminal)	190+0/-3mm(7.48inches)
Weight		Approx 15.5Kg(34.18lbs)
Standard Terminal		1
Cell layout		0
Hold-Down		B13
Cell plate qty		/
Case		Black-PP Material
Cover		Black-PP Material
Handle		Black-PP Material

### Electrical Specification

Rated Capacity	20 hour rate(2.5A)	50Ah
Reserve Capacity		80min
Cold Cranking Performance Amps@0°F(-18°C)		570A

### Standard Terminal (mm)

Terminal Type	D	
	Positive	Negative
1	19.5 <sup>0</sup> <sub>-0.3</sub>	17.9 <sup>0</sup> <sub>-0.3</sub>

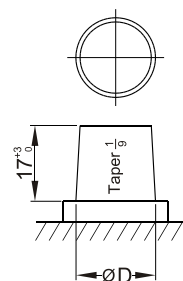

### Cell Layout

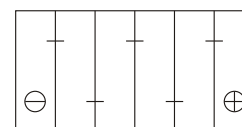

Figure(0)

### Discharge Characteristics(-18°C,0°F)

AGM-L1(CCA-SAE)  
 (CCA-SAE)Capacity Test(@-18)with I=570A  
 Spec  $U_{10S} \geq 7.5V$   $U_{30S} \geq 7.2V$

