

# MAINTENANCE-FREE MOTORCYCLE BATTERY

HPG14A-3-1 (12V12Ah)

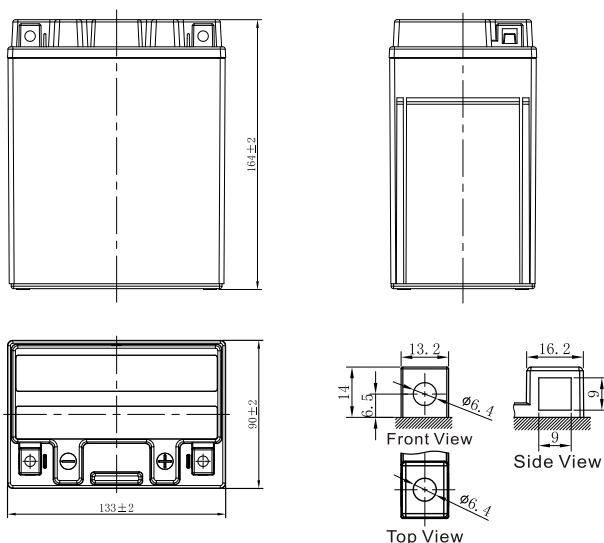

## GENERAL FEATURES

- Longer lifespan
- Lower self-discharge
- Totally Maintenance-free
- Shipped pre-charged and ready to install

\*Values are subject to variation of +/- 5% in normal manufacturing processes.

## CHARACTERISTICS

Item		Specifications
Nominal Voltage		12V
Nominal Capacity (10HR)		12Ah
Cold Cranking Performance Amps@0°F (-18°C)		220A
Dimension (±2mm)	Length	133mm (5.24inches)
	Width	90mm (3.54inches)
	Container Height	164mm (6.46inches)
	Total Height	164mm (6.46inches)
Battery (with acid)	Approx Weight	4.4kg (9.69lbs)
Terminal type		A
Battery type	HPG Series	
Voltage Full Charge	Constant-Voltage Charge:	
	Initial charging current	Less than 0.3C <sub>10</sub>
	14.40V~15.00V at 25°C (77°F)	
	Charging time	15~18h
	Constant-Current Charge:	
	Charging current 0.1C <sub>10</sub> , when charging voltage up to 14.40V, continue to charge 4h	
Floating Charge Voltage	Initial charging current	Unlimited
	13.50V~13.80V at 25°C (77°F)	
Capacity affected by Temperature	40°C (104°F)	106%
	25°C (77°F)	100%
	0°C (32°F)	86%
	-15°C (5°F)	65%

## Discharge Characteristics (25°C, 77°F)

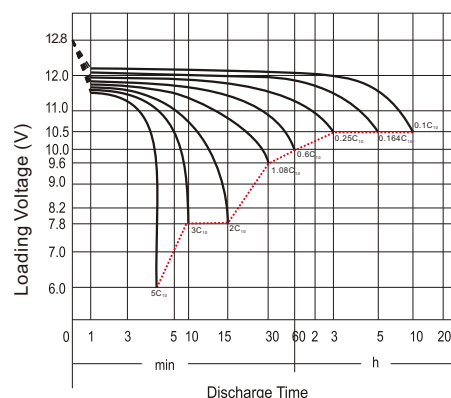

Leoch International Technology Ltd.  
www.leoch.com

Leoch Batteries Pte Ltd  
www.leoch.sg

Leoch Battery Corporation  
www.leochamericas.com

Leoch Europe S.A.  
www.leoch.eu